

A "Site Map" is a scaled drawing showing all existing structures, proposed construction, and relation to all existing private or public roads, existing utilities, utility or other easements & rights-of-way. Your site map should include all of the following:

- ① Property Dimensions (the lot size) in sq. feet  $\leftarrow \cdots \rightarrow$
- ② Dimensions and square footage of all existing structures  $\longleftrightarrow$
- ③ Dimensions and square footage of the proposed structure  $\longleftrightarrow$
- ④ Impervious structures and their dimensions (i.e. sidewalks, paved driveways, concrete patios, etc)  $\longleftrightarrow$
- ⑤ Distance between structures and all property lines  $\longleftrightarrow$
- ⑥ Distance between all structures  $\longleftrightarrow$
- ⑦ Road or street frontage (the width of the front of your lot at the street, for corner or odd shaped lots show width of all sides that face a street)  $\bullet \text{---} \bullet$
- ⑧ Utility locations, easements or any other rights-of-way on the property (if existing)  $\leftarrow \cdots \rightarrow$

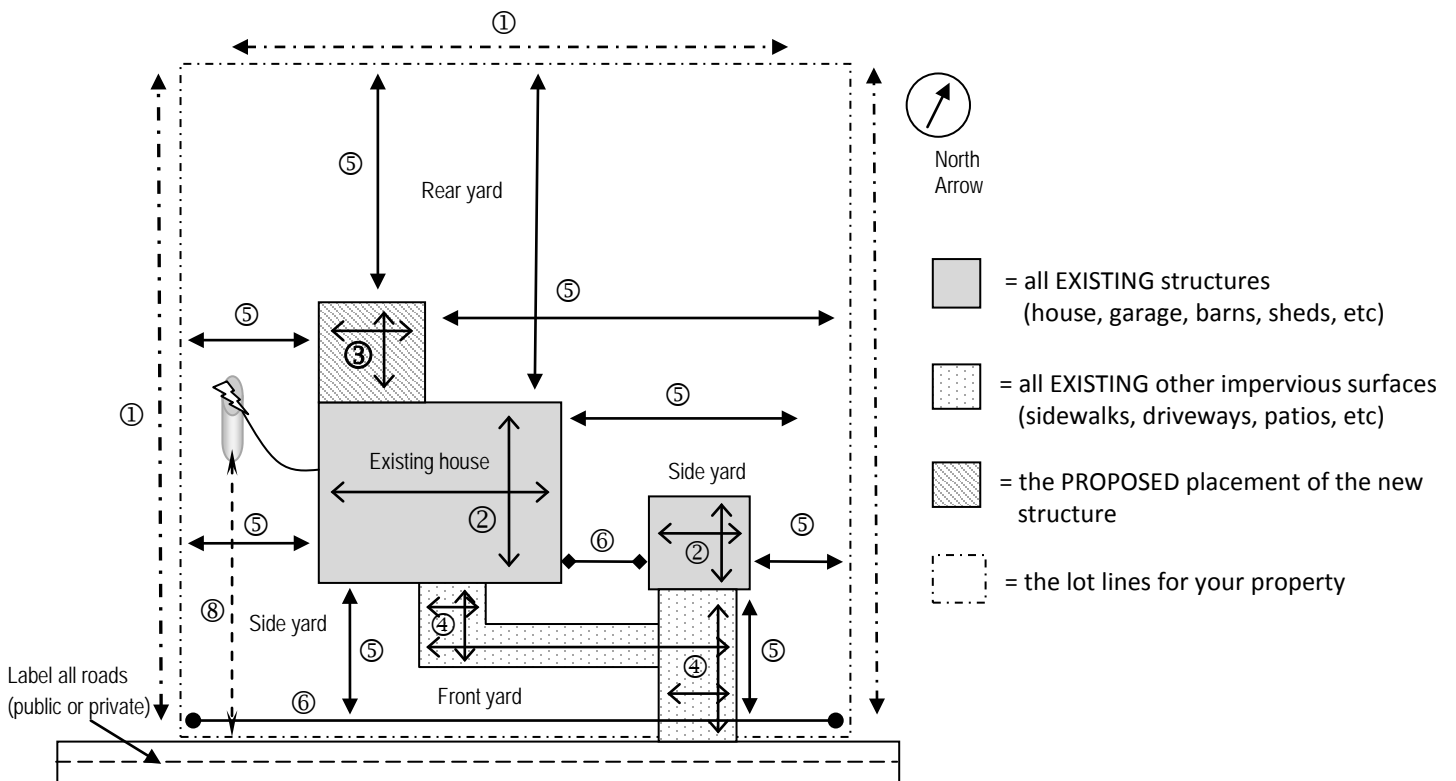

Double-ended arrows ( $\longleftrightarrow$  or  $\longleftrightarrow$ ) indicate where a measurement (in feet) should be included by the owner and/or Applicant. If there are any questions, please ask the Zoning Officer or office staff.